

BELT SPECIFICATIONS

Crimp Wire Size: 0.135 Inches [3.43 mm]
 Spiral Wire Size: 0.106 Inches [2.68 mm]
 Lateral Pitch: 1 Inches [25.4 mm]
 Longitudinal Pitch: 1.2 Inches [30.5 mm]

MATERIAL: PER ORDER
 BELT WIDTH: PER ORDER

THIS DRAWING CONTAINS CONFIDENTIAL INFORMATION AND TRADE SECRETS OF ASHWORTH BROS., INC. IT MAY NOT BE REPRODUCED IN WHOLE OR IN PART, OR USED FOR THE BENEFIT OF ANYONE OTHER THAN ASHWORTH BROS., INC. NO RIGHT IS GRANTED TO DISCLOSE OR USE ANY INFORMATION SHOWN ON THIS DRAWING.

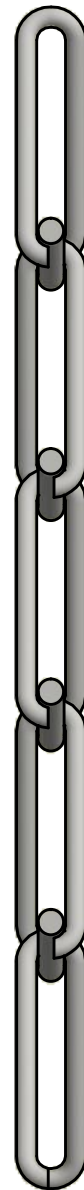
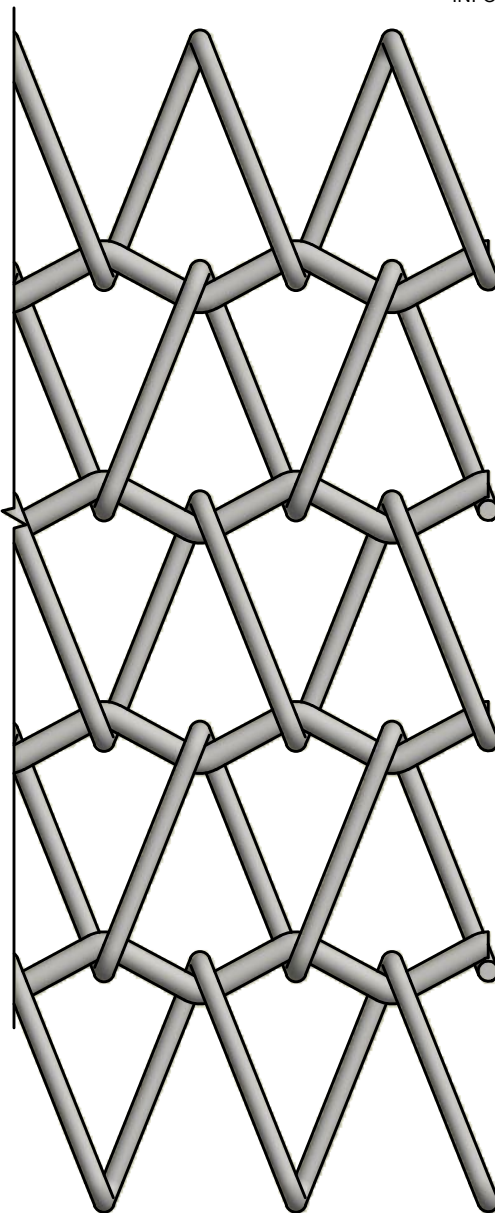
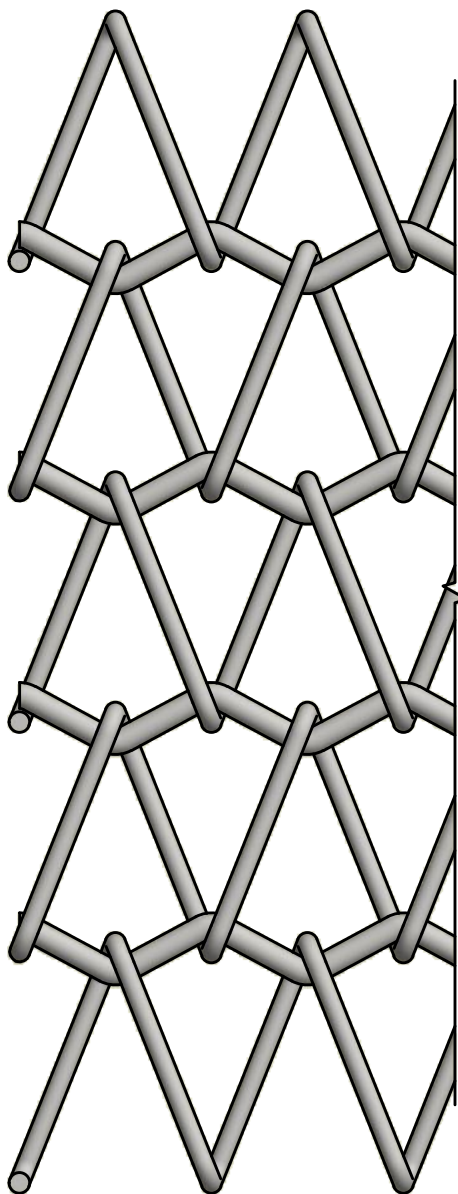

DO NOT SCALE DRAWING

APPROVALS

DATE

DRAWN

NEC

3/15/18

TITLE

Ashworth Bros., Inc.

450 ARMOUR DALE, WINCHESTER, VA 22601

ILLUSTRATION

Woven Belt B12-10-1012

UNLESS OTHERWISE SPECIFIED DIMENSIONS ARE IN INCHES.

TOLERANCES:

.X = ± .03 FRACTION ± 1/16
 .XX = ± .015 ANGLES ± 1/2°
 .XXX = ± .005
 .XXXX = ± .0005 SURF FINISH 63 ✓

SIZE

A

DWG. NO.

B012-010-1012

REV.

CAD/FILE NAME

BW Assy w Disclaimer.idw

SCALE

NTS

CALC.WT

N/A

SHEET

1 OF 1